

Capitol Extension

EXTENSION FIRST FLOOR

State Representatives:
E1.200's through E1.500's

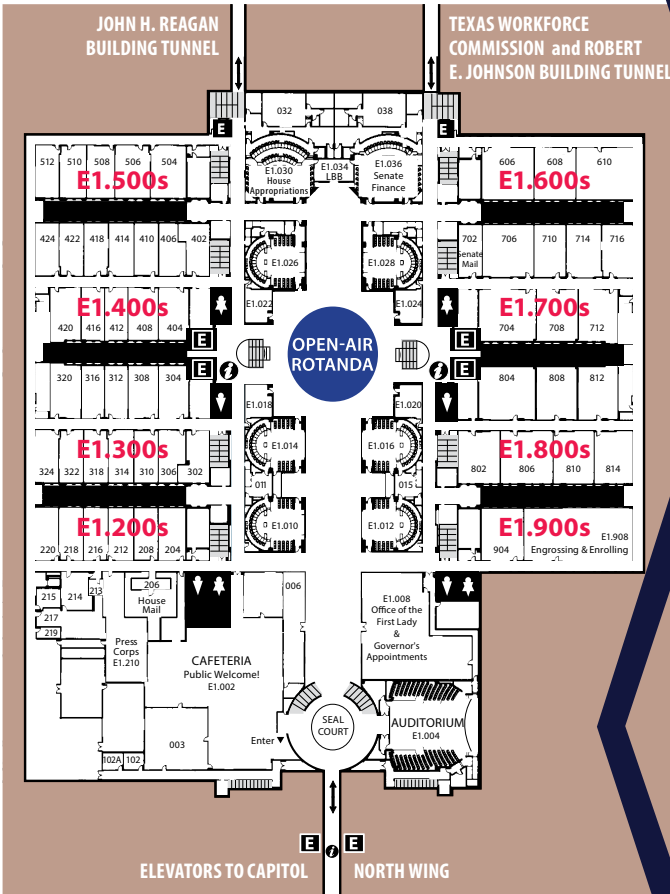

CAPITOL EXTENSION ACCESS:

Take the North Wing elevators to Floor E1 or E2 of the underground Capitol Extension.

EXTENSION SECOND FLOOR

State Representatives Offices
E2.200 through E2.900's

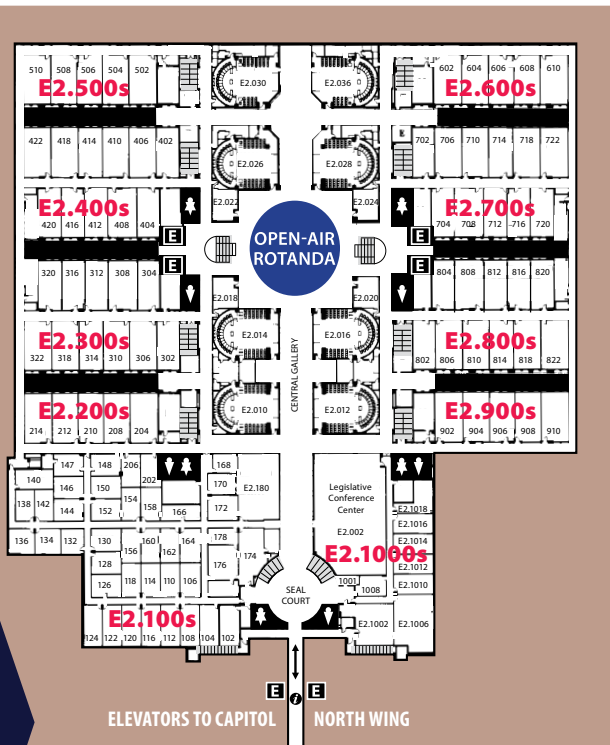

Senators:
E1.600's through E1.800's

- Underground facilities
- Ground level facilities
- Above ground facilities

HOUSE COMMITTEE STAFF SUITES

E2.100's E2.202 & E2.206

Texas Capitol

SAM HOUSTON BLDG.

CAPITOL MAPS

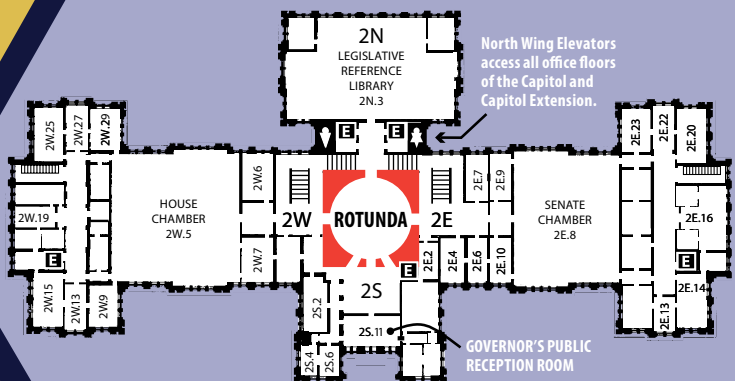
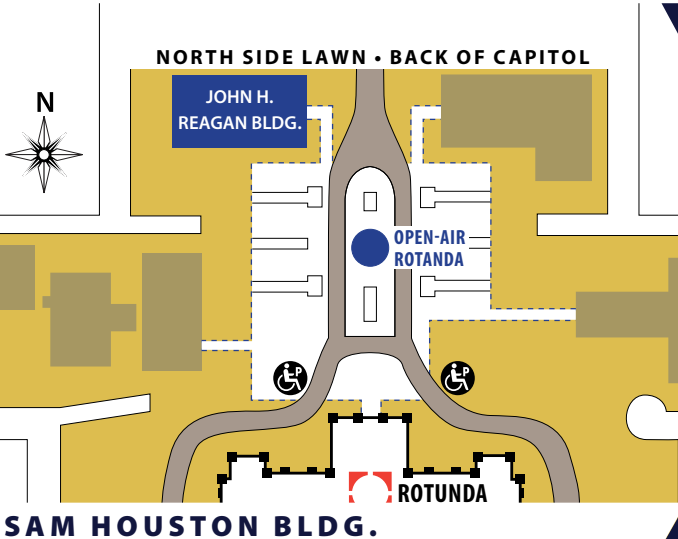

SECOND FLOOR

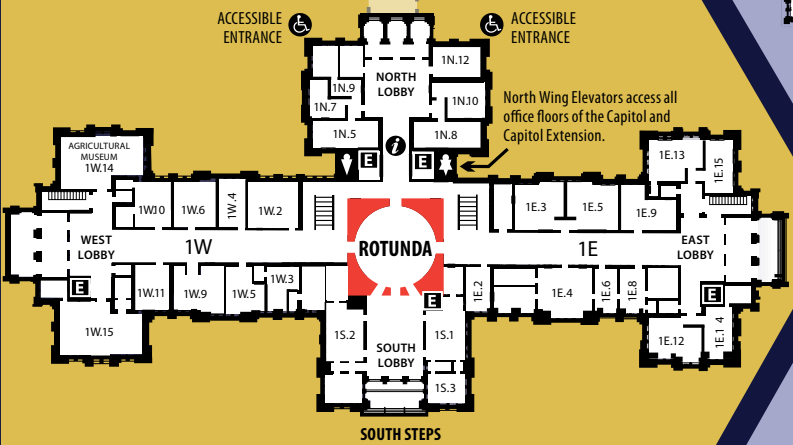

FIRST FLOOR

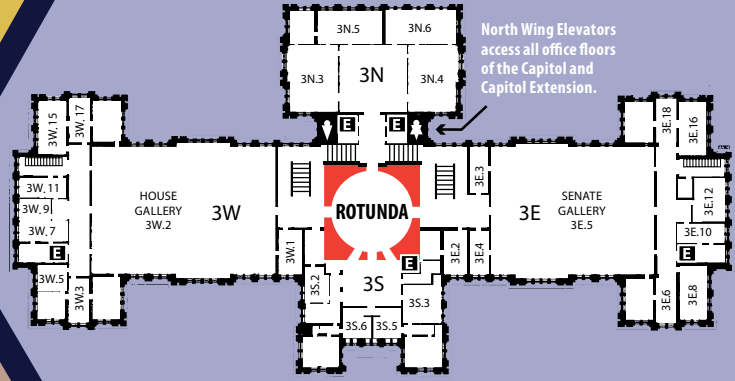

THIRD FLOOR

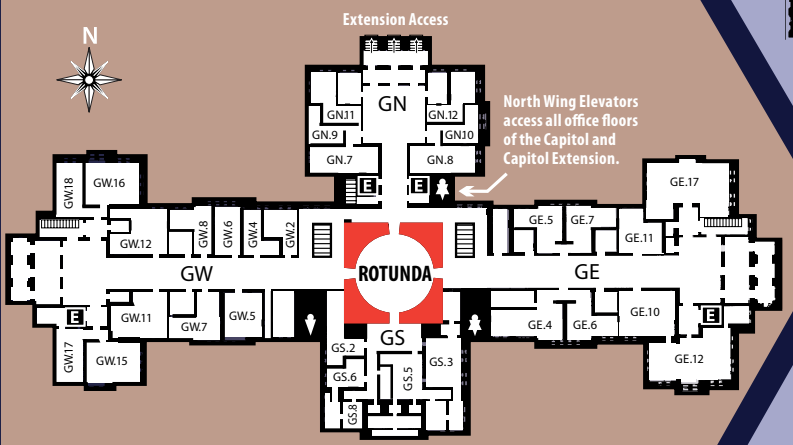

GROUND FLOOR (BASEMENT)

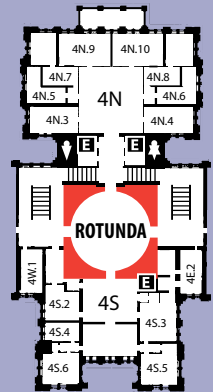

FOURTH FLOOR